

Section 2 Hubs, Drums & Studs

Studs & Nuts

Serrated Wheel Studs



| Part Number | Description |
|-------------|--|
| MER09001862 | Stud 22MM Hub Piloted 4.78" (09002003) |
| MER09001910 | Stud .75" RH Ball Seat Mount 2.63" |
| MER09001911 | Stud .75" LH Ball Seat Mount 2.63" |
| WEB101160 | Stud 22MM Hub Piloted 4.91" |
| WEB101162 | Stud 22MM Hub Piloted 4.00" |
| WEB101172 | Stud .75" RH Ball Seat Mount 2.91" |
| WEB101173 | Stud .75" LH Ball Seat Mount 2.91" |
| HAY106201 | Stud .75" RH Ball Seat Mount 2.60" (3008401) |
| HAY106202 | Stud .75" LH Ball Seat Mount 2.60" (3008402) |
| HAY3018501 | Stud 22MM Hub Piloted 4.59" |
| HAY3018503 | Stud 22MM Hub Piloted 3.66" |
| HAY88836 | Stud 22MM WHD-8 Clipped Head 3.58" |
| BWPM-80 | Stud .75" RH Ball Seat Mount 2.88" |
| BWPM-81 | Stud .75" LH Ball Seat Mount 2.88" |

Wheel Nuts Flanged



| Part Number | Description |
|-------------|---------------------------------|
| HAY3208401 | 22MM Flange Nut 33MM Hex |
| HAY88881 | 22MM Flange Nut 1.50" Hex WHD-8 |

Section 2 Hubs, Drums & Studs

Studs & Nuts



| Part Number | Description |
|-------------|----------------------------------|
| 10708 | Inner Cap Nut RH Steel Wheels |
| 10709 | Inner Cap Nut LH Steel Wheels |
| 43060 | Inner Cap Nut RH Aluminum Wheels |
| 43061 | Inner Cap Nut LH Aluminum Wheels |



| Part Number | Description |
|-------------|-------------------------------|
| 37891 | Outer Cap Nut RH Steel Wheels |
| 37892 | Outer Cap Nut LH Steel Wheels |



| Part Number | Description |
|-------------|-----------------------------|
| BWPM-39 | Stud .75" Spoke Wheel 2.81" |

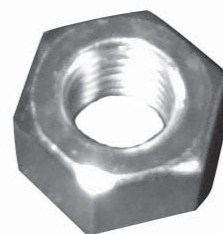

| Part Number | Description |
|-------------|--------------------------------|
| BWPM-45 | Nut .75" Spoke Wheel 1.25" Hex |